

# NUMBERING OF FLOORS AND ROOMS

Applicable to:

- Acton Campus
- Remote Sites



Australian  
National  
University



# Current Standards

Numbering of floors and rooms in new buildings and refurbishment of spaces - Staff Services - ANU

## Numbering of floors

Floor Name	Floor Level Prefix
Below natural ground level	B1, B2
Lowest on-grade entrance level	L1
Next level above lowest on-grade entrance level	L2

## Numbering of rooms

Room numbers are to consist of the floor level prefix, followed by the individual room number, example below:

Floor Level Prefix	Room Numbering
B1	B1.01, B1.02, B1.03, etc
L1	1.01, 1.02, 1.03, etc
L2	2.01, 2.02, 2.03, etc

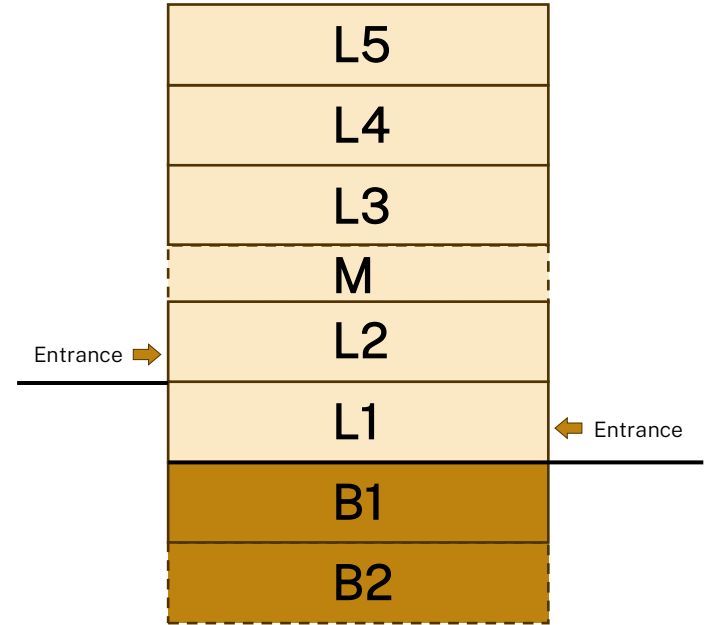

**Image above:** section showing numbering of floors for buildings with multiple main entrances at different floor levels

Please note that there is no Roof level, B level, LG level, and G level.



# Current Standards

## Numbering of rooms/sub-rooms



**Floor Number**  
B1, 1, 2, etc

**Room Number**  
01, 02, 03, etc

**Suffix Letters**  
A,B,C, etc



1	01	A	1.01A
3	06	N/A	3.06
4	12	N/A	4.12
B1	27	C	B1.27.C

## Numbering of workstations



**Floor Number**  
B1, 1, 2, etc

**Room Number**  
01, 02, 03, etc

**Workstations**  
01,02,03, etc



1	01	04	1.01.04
3	06	12	3.06.12
4	12	15	4.12.15
B1	27	23	B1.27.23



# Current Standards

## Examples : Numbering of rooms/sub-rooms

Room numbering is to **commence with the main entrance lobby**, thence continue from the left-hand side, running in a **clockwise direction** (when viewed in plan) around the building

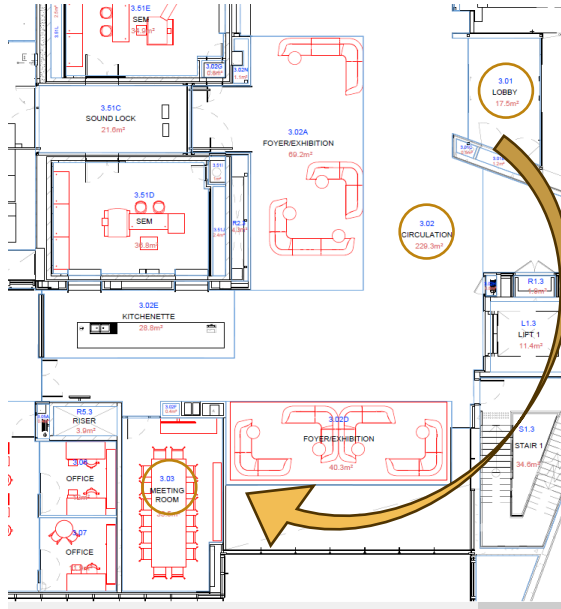

Image above: Building 160 Level 3 floor plan

Rooms which are **accessed via other rooms**, are considered to be sub-sets of the entry room, and should be given the number of the entry room with a **suffix A, B, C** etc.

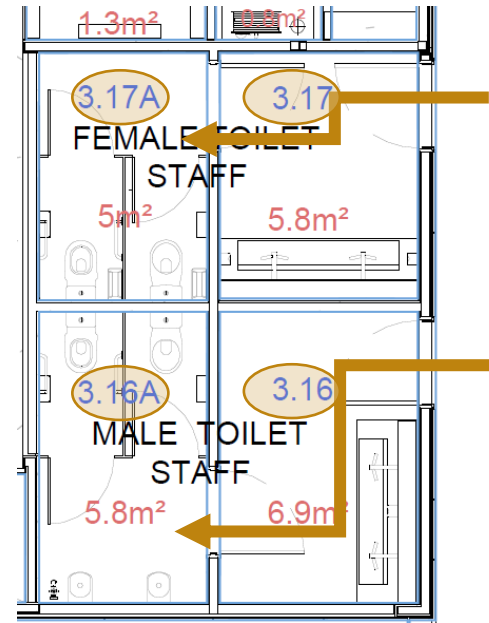

Image above: Building 160 Level 3 floor plan



# Current Standards

## Examples : Numbering of workstations



Image above: Building 123 Level 3 floor plan

